

UZ 934

Model:
UZ 934



Part List English

20-11-2013

Table of Contents

UZ 934

Cover and Container	3
Filter, fan and cord	5
Nozzles, hose and tube	7
RECOMMENDED SPARE PARTS	9

Cover and Container

UZ 934

20-11-2013

Part List ID
B0633_2

3

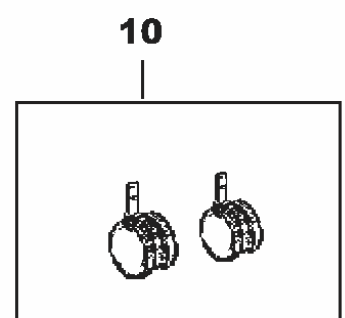
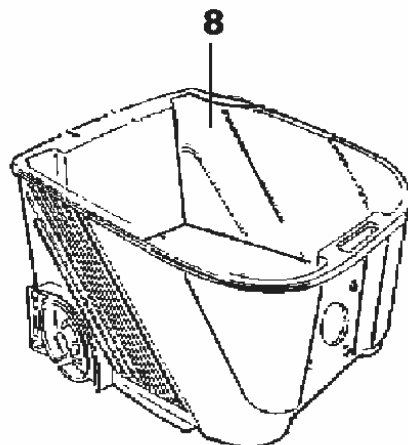
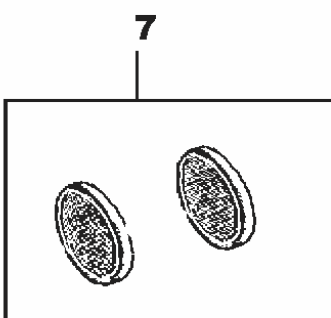
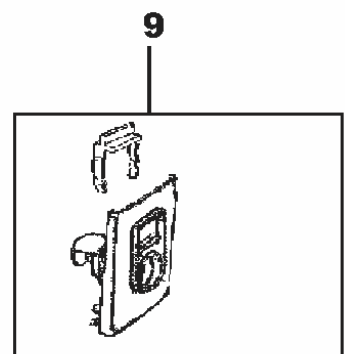
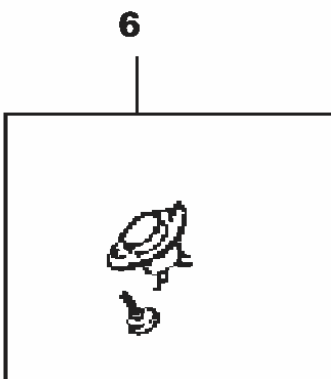
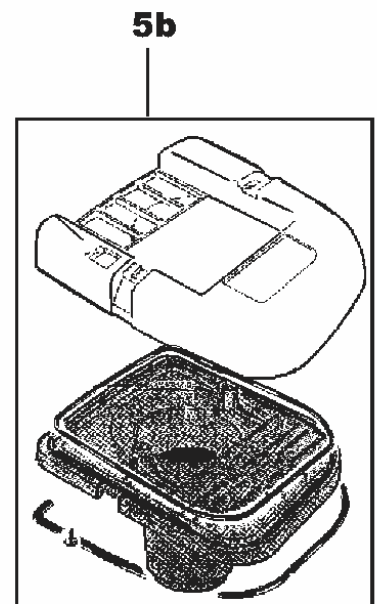
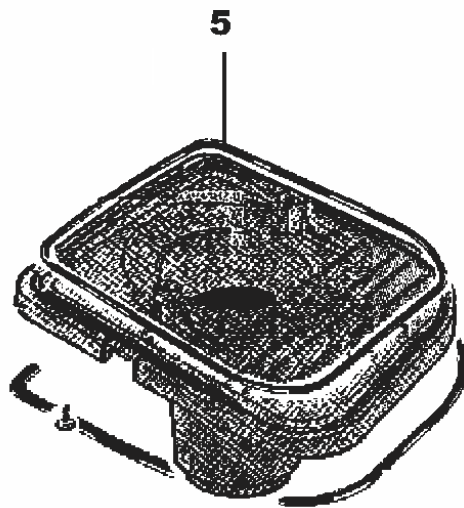
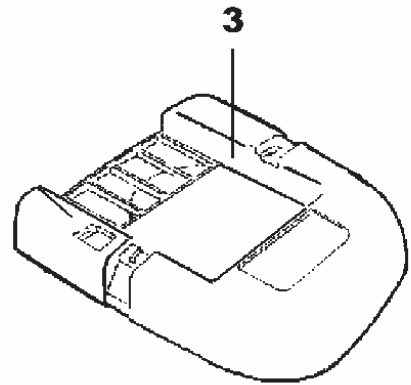
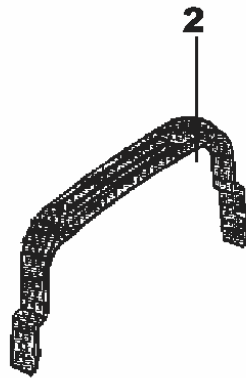
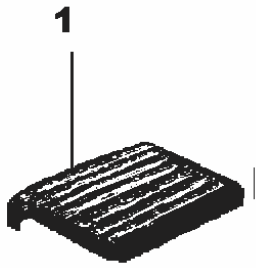

Cover and Container

UZ 934

20-11-2013

Part List ID

B0633_2

4

Pos	Part no.	Qty	Description
0	140 7787 010	1	BOX FOR UZ 934
1	140 6873 500	1	GRATING FOR FILTER UZ934
2	140 6872 020	1	HANDLE IN PINK
2	140 6872 500	1	HANDLE UZ 934
3	140 6871 500	1	COVER,UPPER GREY
3	140 6871 520	1	COVER, UPPER UL BLUE UZ 9
3	140 6871 530	1	COVER UPPER GREEN
3	140 6871 590	1	COVER UPPER RED
4	140 5496 510	1	SWITCH UL KIT INSULTATION COVER INCLUDE
5	140 6870 500	1	COVER LOWER, KIT GASKETS & SCREWS INCLUDED
5	140 6870 510	1	COVER LOWER UL KIT
5	140 6870 520	1	COVER LOWER UL KIT
6	140 3894 500	1	THERMO PROTECTION KIT SCREW AND WIRE INCLUDED
7	140 8458 500	1	WHEEL KIT 2 REAR WHEELS
8	140 6408 500	1	CONTAINER BLUE UZ 934
8	140 6408 510	1	CONTAINER GREY UZ 964
8	140 6408 520	1	CONTAINER YELLOW
8	140 6408 600	1	CONTAINER ALTO BLUE UZ934
8	140 6408 610	1	CONTAINER ORANGE UZ934
9	140 7205 500	1	TRIGGER KIT UZ 934 HOSE INLET INCLUDED
10	140 6422 500	2	LINK WHEELS KIT 2 WHEELS

NOTE: Part number 140 6871 520 cover upper UL blue, is cancelled.

The cover upper UL blue part, is instead included in item 5b part number 140 6870 520

Filter, fan and cord

UZ 934

20-11-2013

Part List ID
B0635_2

5

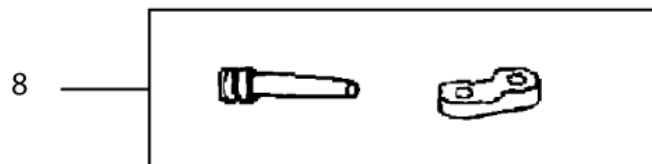
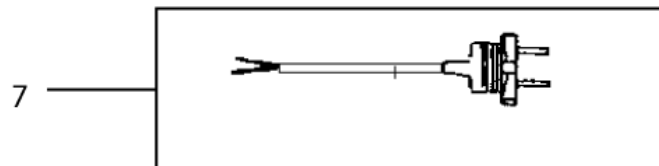
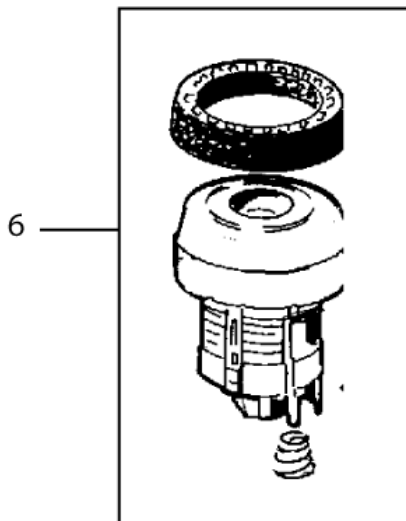
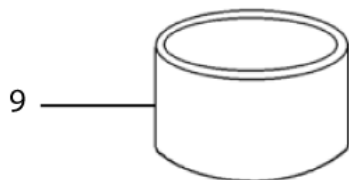
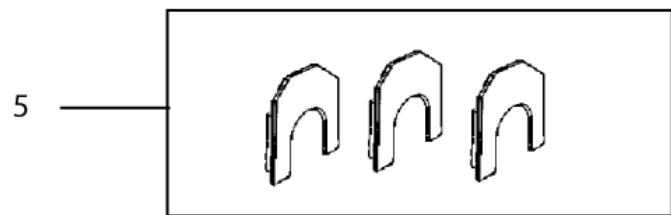
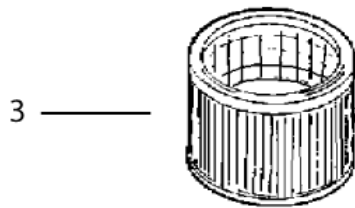
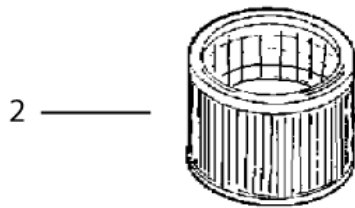
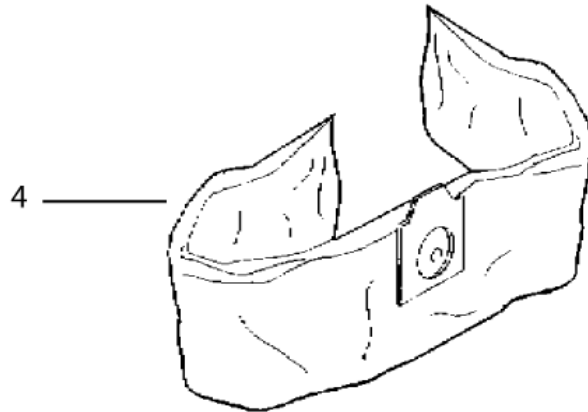
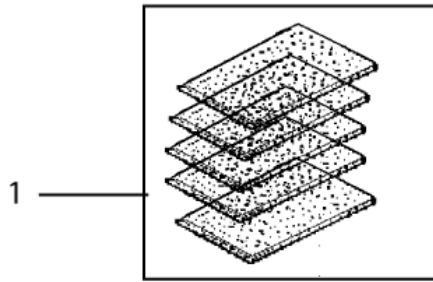

Filter, fan and cord

UZ 934

20-11-2013

Part List ID

B0635_2

6

Pos	Part no.	Qty	Description	
0	140 8163 010	1	NYLON FILTER	not shown
1	140 6879 500	5	EXHAUST FILTER KIT 5 FILTERS	
2	140 6880 500	1	MAIN FILTER UZ 934	
3	140 7542 010	1	HEPA FILTER CPL	
4	140 5612 000	1	CLOTH DUST BAG UZ 934	
4	140 6905 020	10	DUST BAG 10-PACK UZ 934	
5	140 6744 500	3	LOCK WASHER UZ 934 pack of 3	
6	140 7902 500	1	FAN UNIT 230V UZ930s	
6	140 7902 510	1	FAN UNIT 110-120V 1000W	
6	140 7902 520	1	FAN UNIT 240V UZ934	
6	140 7902 530	1	FAN UNIT KIT DOMEL 100V	
7	140 6423 500	1	CORD EU L=15M	
7	140 6423 510	1	CORD EU L 10M	
7	140 6423 520	1	CORD KIT CH L 15M	Machine outphased 2010
7	140 6423 530	1	CORD UK L=15M	
7	140 6423 540	1	CORD UK L=10M	
7	140 6423 550	1	CORD US PLUG L 15M	
7	140 6423 560	1	CORD US L 10M GROUNDED	
7	140 6423 570	1	CORD JP L 15M	
7	140 6423 580	1	CORD AU L 15.5M	
7	140 6423 590	1	CORD EU RED L 12.7M	
8	140 7035 500	1	PROTECTION SLEEVE KIT SLEEVE AND ANTI STRAIN CL	
8	140 7035 510	1	PROTECTION SLEEVE US KIT	
9	140 6667 040	1	FILTER L=130	

Nozzles, hose and tube

UZ 934

20-11-2013

Part List ID
B0637_2

7

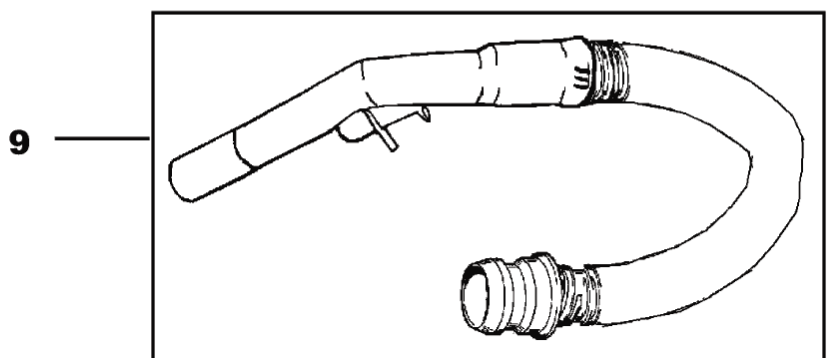
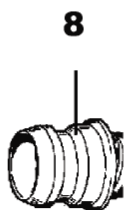
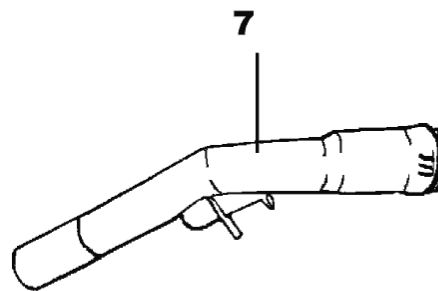
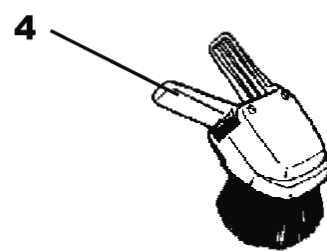
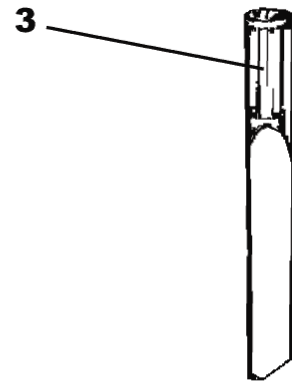
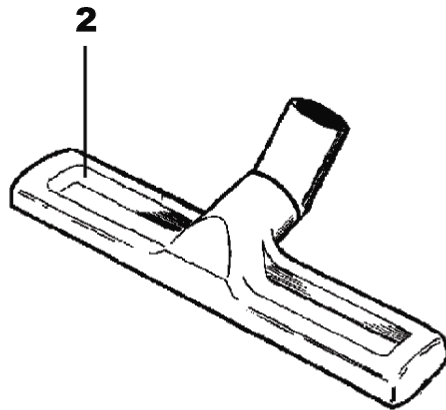
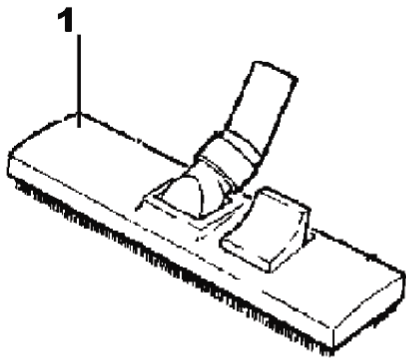

Nozzles, hose and tube

UZ 934

20-11-2013

Part List ID

B0637_2

8

Pos	Part no.	Qty	Description
1	11980300	1	COMBI NOZZLE 32MM
2	140 6701 500	1	MULTI SURFACE NOZZLE DIAMETER 32 MM
3	010 3098 500	1	CREVICE NOZZLE
4	011 3104 500	1	SMALL COMBI NOZZLE ROUND BRUSH/UPHOLSTERY
5	011 8130 500	1	TELESCOPIC TUBE 32MM
6	011 6431 500	1	TUBE 32MM X 500MM LONG
7	140 7584 500	1	HANDLE CPL. HOSE HANDLE FOR 32 MM HOS
8	140 3304 500	1	INLET SLEEVE
9	140 6430 500	1	HOSE PLASTIC, D32 MM L 1 SNAP IN COUPLING, PLASTIC

RECOMMENDED SPARE PARTS

UZ 934

20-11-2013

Part List ID B0639

9

No Drawing For Part List

RECOMMENDED SPARE PARTS

UZ 934

20-11-2013

Part List ID

B0639

10

Pos	Part no.	Qty	Description
1	140 3894 500	1	THERMO PROTECTION KIT SCREW AND WIRE INCLUDED
1	140 5496 510	1	SWITCH UL KIT INSULTATION COVER INCLUDE
1	140 5612 000	1	CLOTH DUST BAG UZ 934
1	140 6408 500	1	CONTAINER BLUE UZ 934
1	140 6408 510	1	CONTAINER GREY UZ 964
1	140 6408 520	1	CONTAINER YELLOW
1	140 6408 600	1	CONTAINER ALTO BLUE UZ934
1	140 6408 610	1	CONTAINER ORANGE UZ934
1	140 6422 500	1	LINK WHEELS KIT 2 WHEELS
1	140 6423 500	1	CORD EU L=15M
1	140 6423 510	1	CORD EU L 10M
1	140 6423 520	1	CORD KIT CH L 15M Machine outphased 2010
1	140 6423 530	1	CORD UK L=15M
1	140 6423 540	1	CORD UK L=10M
1	140 6423 550	1	CORD US PLUG L 15M
1	140 6423 560	1	CORD US L 10M GROUNDED
1	140 6423 570	1	CORD JP L 15M
1	140 6423 580	1	CORD AU L 15.5M
1	140 6423 590	1	CORD EU RED L 12.7M
1	140 6667 040	1	FILTER L=130
1	140 6744 500	1	LOCK WASHER UZ 934 pack of 3
1	140 6880 500	1	MAIN FILTER UZ 934
1	140 6905 020	1	DUST BAG 10-PACK UZ 934
1	140 7205 500	1	TRIGGER KIT UZ 934 HOSE INLET INCLUDED
1	140 7542 010	1	HEPA FILTER CPL
1	140 7902 500	1	FAN UNIT 230V UZ930s
1	140 7902 510	1	FAN UNIT 110-120V 1000W
1	140 7902 520	1	FAN UNIT 240V UZ934
1	140 7902 530	1	FAN UNIT KIT DOMEL 100V
1	140 8458 500	1	WHEEL KIT 2 REAR WHEELS